

Nr Lands End  
ENGLAND

**SEER ROCKDUST TRIAL**

I used SEER Rockdust, kindly brought down from Scotland for me by a good friend, on my vegetable plot.

The site is 4 or 5 miles north of Land's End and it is small and exposed.

The trial involved Maris Bard first early potatoes, planted in 3 adjacent rows, the centre row only being treated with 0.5kg to 1kg SEER Rockdust per square metre.

The centre row treated crop averaged 1lb 8½oz of potatoes per root, the other two untreated rows averaged 1lb 2oz and 16¾oz of potatoes respectively, per root.

As the attached diagram shows, the yield for the treated roots were therefore 26.5% and 31.6% heavier than the untreated.

I would say this was an impressive result for my first trial of using SEER Rockdust and I am suitably impressed.

Yours truly,

FRANK W

# IMPROVED POTATO YIELD

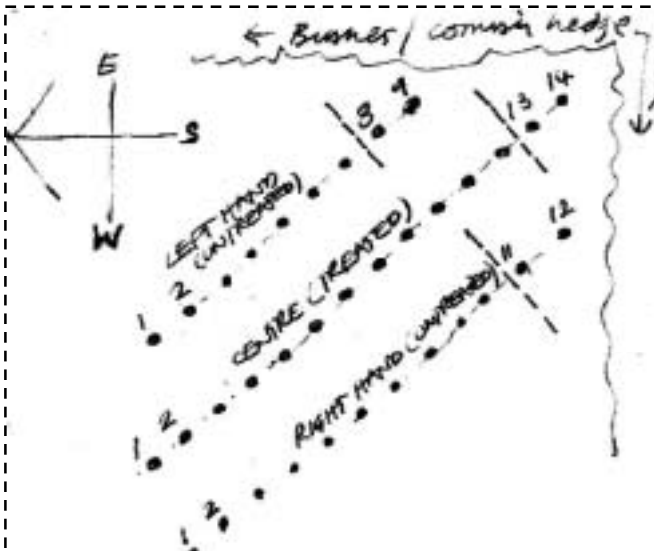

TYPE: MARIS BARD.  
SOWN: 30th MARCH 2005.  
COMPOST: WELL ROTTED HORSE MANURE OVER WHOLE PLOT  
TREATMENT: CENTRE ROW ONLY: ABOUT 0.5 TO 1.0kg / m<sup>2</sup> ROCK DUST SPRINKLED ON AT SOWING.

ROOT NO.	LEFT ROW UNTREATED				CENTRE ROW TREATED				RIGHT ROW UNTREATED			
	DATE	WEIGHT	DAYS		DATE	WEIGHT	DAYS		DATE	WEIGHT	DAYS	
1	19/6	1 lb 8½	81		15/6	1 lb 8½	77		14/6	1 lb 3	7	
2	4/7	13¾			19/6	1 lb 12	80		24/6	1 lb 12½	8	
3	4/7	1 lb 4			21/6	1 lb 11	83		23/6	1 lb 3	8	
4	5/7	1 lb 8½			26/6	1 lb 7	88		30/6	1 lb 2	9	
5	5/7	1 lb 14			28/6	1 lb 12½	90		30/6	1 lb 0	9	
6	14/7	7oz			21/7	1 lb 14	94		5/7	1 lb 0½	9	
7	14/7	1 lb 3¾	106		9/7	1 lb 11	97		5/7	1 lb 15	9	
8	14/7	9oz			5/7	1 lb 1	97		14/7	1 lb 3	10	
9	14/7	7½			11/7	1 lb 11	103		14/7	1 lb 13½	10	
10					11/7	1 lb 13½	103		11/7	1 lb 11¾	10	
11					11/7	1 lb 11½	103		11/7	7¾	10	
12					14/7	1 lb 8½	106		11/7		10	
13					18/7	7						
14					18/7	2¾						

IN each case, missing off the final roots as these were right under potatoes bushes - finished to say nothing of Sycamore sapling (and mixed up) with the roots, stoned if under etc.

CONTROLLED	LEFT ROW	7 roots	126oz = 1 lb 2oz per root
TREATED	CENTRE	12 roots	249 ¼oz = 1 lb 8 ½oz per root
UNTREATED	RT.	10 roots	167 ¾oz = 1 lb 7 ¾oz per root

Yield from treated roots between 26.5% and 31.6% heavier than untreated. impressive I think.